

IOTA XS/PM

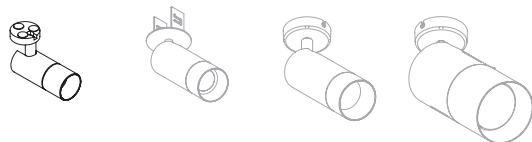

IOTA XS/PM IOTA S/P IOTA M/P IOTA L/P

MAGNETIC INDOOR SCONCE SPOTLIGHT RANGE

This miniature projector has a magnetic sconce. In addition to being extremely discreet and efficient, installation is simple. It can be magnetized to any metallic surface and screwed to any other surface.

Designed to be reused at will and to accompany you in all your projects, this luminaire is ideal for exhibitions. Installation and removal is simple by clipping and unclipping the fixtures.

The IOTA XS can be rotated through 355° and can be adapted to your configurations. Designed specifically for accent and precision lighting, it enhances the subject being lit while remaining inconspicuous.



*

*IOTA XS/PM /M (MEDIUM SNOOT)

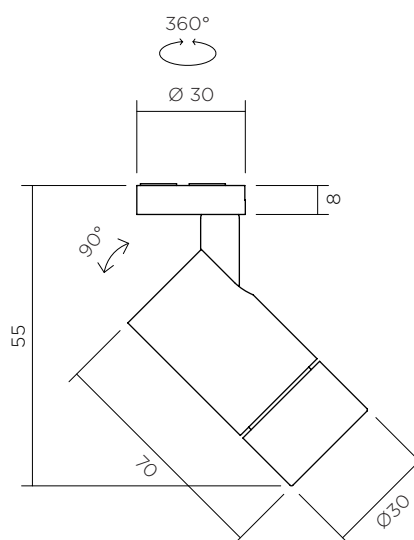

IOTA XS/PM MEDIUM SNOOT SCHEME

FEATURES

- Mounted on magnetic sconce
- Ultra-compact
- Direct-current power supply via driver
- LED voltage : 3,2vdc@1400mA
- Optics: from 10° to 55°
- Colour temperatures: 2700°k, 3000°k, 3500°k, 4000°k
- Up to 300 Lumens
- 3 MacAdam steps

OPTIONS

- Other fixtures
- Other colour temperatures
- Other beams
- Other finishes (powder-coated paint)

ACCESSORIES

- Elliptical filters
- Honeycomb grille
- Short front panel

CONTROL*

- ON / OFF
- 0-10 V
- DALI
- DMX
- Wireless

*According to driver choice



IOTA XS/PM MAGNETIC SCC



IOTA XS/PM SNOOT
From left to right
SHORT (C), MEDIUM (M), LONG (L)

IOTA XS/PM

850°
   
 90°
 **0,2** IP IRC UGR
 KG 40 >90 <19



*

*IOTA XS/PM /L (SNOOT LONG)

POWER* AND PHOTOMETRY

INDICATIVE DATA FOR LED 2700° K IRC92 WITH HONEYCOMB GRILLE

LED type	Voltage	Max direct current	Power	Beams	Candelas in the axis	Lumens output
LED	3,2 vdc	1 400 mA	4,5 W	10°	5 062 Cds	316 Lms
				12°	3 249 Cds	259 Lms
				15°	2 131 Cds	271 Lms
				19°	1 366 Cds	246 Lms
				22°	1 072 Cds	246 Lms
				27°	1 089 Cds	283 Lms
				33°	754 Cds	275 Lms
				44°	471 Cds	275 Lms



Connection to a direct current driver (to be ordered separately).

Devices must be connected to the driver before switching them on.
 Failure to respect this requirement will damage the devices irreversibly.

*Data may change according to developments in LED technology

OTHER VERSIONS

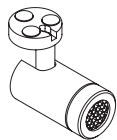

IOTA XS/PM/C
 MAGNETIC SCONCE
 SHORT SNOOT

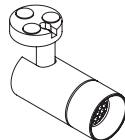

IOTA XS/PM/M
 MAGNETIC SCONCE
 MEDIUM SNOOT

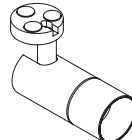

IOTA XS/PM/L
 MAGNETIC SCONCE
 SHORT SNOOT



IOTA XS/PF
 FIXED SCONCE
 INKING UNIT

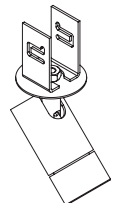

IOTA XS/PFE
 FIXED SCONCE
 ENCLOSURE