

IOTA **XXS**/P

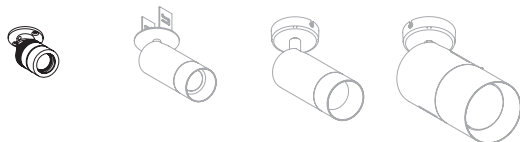

75° **0,03** IRC >90 IP 40 UGR <19
KG



IOTA XXS/P IOTA S/P IOTA M/P IOTA L/P

INDOOR **SCONCE SPOTLIGHT** RANGE

This ultra-compact and powerful spotlight combines elegance and discretion. Ideal for precision lighting, this light is distinguished by its small size. Perfectly suited to fit into both shop windows or furniture, this miniature spotlight will highlight and accentuate your objects while remaining discreet.

The wide range of optics, finishes and colour temperatures make the IOTA S a particularly versatile product.

FEATURES

- Mounted on sconce
- Direct-current power supply via driver
- LED voltage: 3.2vdc@700mA
- Optics: from 12° to 21°
- Colour temperatures: 2700° k, 3000° k, 3500° k, 4000° k
- Up to 100 Lumens
- 2 MacAdam steps

OPTIONS

- Other colour temperatures
- Other beams
- Other finishes (*custom RAL*)
- Other fixtures

ACCESSORIES

- Elliptical filters
- Honeycomb grille
- Short front panel

CONTROL*

- ON/OFF
- 0-10 V
- DALI
- DMX
- Wireless

*According to driver choice



SNOOT SHORT

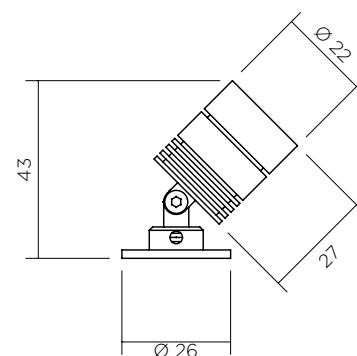



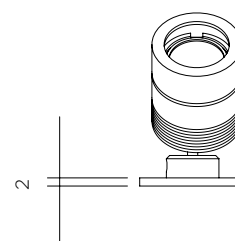
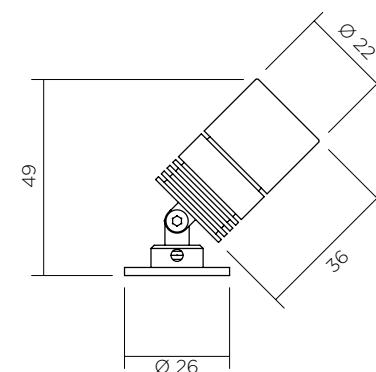

SNOOT LONG



ULTRA COMPACT
IOTA XXS SMALL SIZE.

IOTA **XXS**/P

850°
   
 75° **0,03** IRC IP UGR
 KG >90 40 <19



POWER* AND PHOTOMETRY

INDICATIVE DATA FOR LED 3000° K IRC90 WITH HONEYCOMB GRILLE

LED type	Voltage	Max direct current	Power	Beams	Candelas in the axis	Lumens output
LED	3,4 vdc	700mA	2,4W	12,3°	2 147 Cds	112 Lms
				23,8°	613 Cds	122 Lms
				36°	302 Cds	120 Lms
				50,5°	117 Cds	88,9 Lms
				59,9°	100 Cds	92,6 Lms
	Connection to a direct current driver (to be ordered separately).					
	Devices must be connected to the driver before switching them on. Failure to respect this requirement will damage the devices irreversibly.					
	*Data may change according to developments in LED technology					