

ETA/P

850°  

90°  355°  **0,43** IRC >90 IP 20
KG

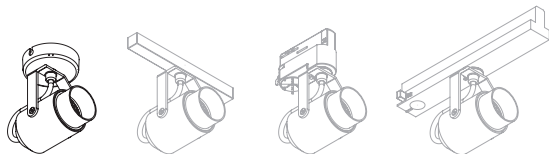

ETA/P ETA/R48 ETA/230V ETA/230V CC

INDOOR RETROFIT RANGE

SCONCE SPOTLIGHT

Particularly distinguished by its compactness and looks, this sconce spotlight is economical and offers fantastic quality.

Perfect for retrofitting, the light can be easily swapped out thanks to the low-luminance screwed cylinder.

As discreet as it is efficient, this light is capable of accentuating even the most demanding of indoor projects.

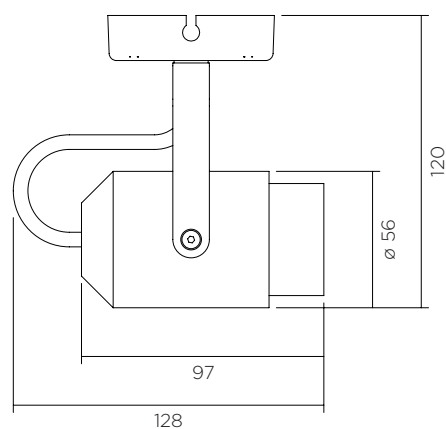

FEATURES

- Colour temperatures: 2700° k, 3000° k, 4000° k
- LED retrofit light in GZ10 or GU10 (230V)
- Direct-current LED module

OPTIONS

- Other beams
- Other finishes (*powder-coated painting*)

ACCESSORIES

- Filtres elliptiques
- Grille nid d'abeille
- Cône, cylindre ou casquette

PILOTAGE *

- ON/OFF
- 0-10V
- DALI
- Wireless

*According to driver choice



ALTERNATIVE VERSION
ON 48-VDC BAR

ETA/P

850°
  
 90°  355°  **0,43** IRC IP
 KG >90 20



POWER* AND PHOTOMETRY*

INDICATIVE DATA FOR LED 3000° K

LED type	Voltage	Max direct current	Power	Beams	Candelas in the axis	Lumens output
	35 Vdc	350 mA	12 W	19°	6 080 Cds	1 050 Lm
23°				4 966 Cds	1 098 Lm	
35°				2 308 Cds	1 007 Lm	

*Other photometries available depending on chosen source



Connection according to choice of module.

Devices must be connected to the driver before switching them on.
 Failure to respect this requirement will damage the devices irreversibly.

AUTRES VERSIONS

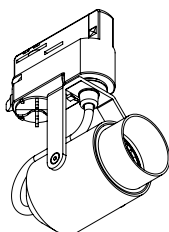

ETA /R230
 ON 230-V BAR

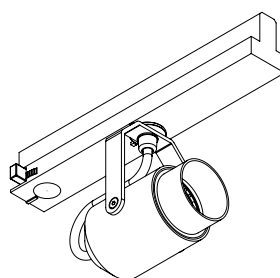

ETA /R230CC
 ON 230-V-CC BAR

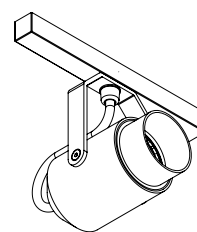

ETA /R48
 ON 48-V BAR